

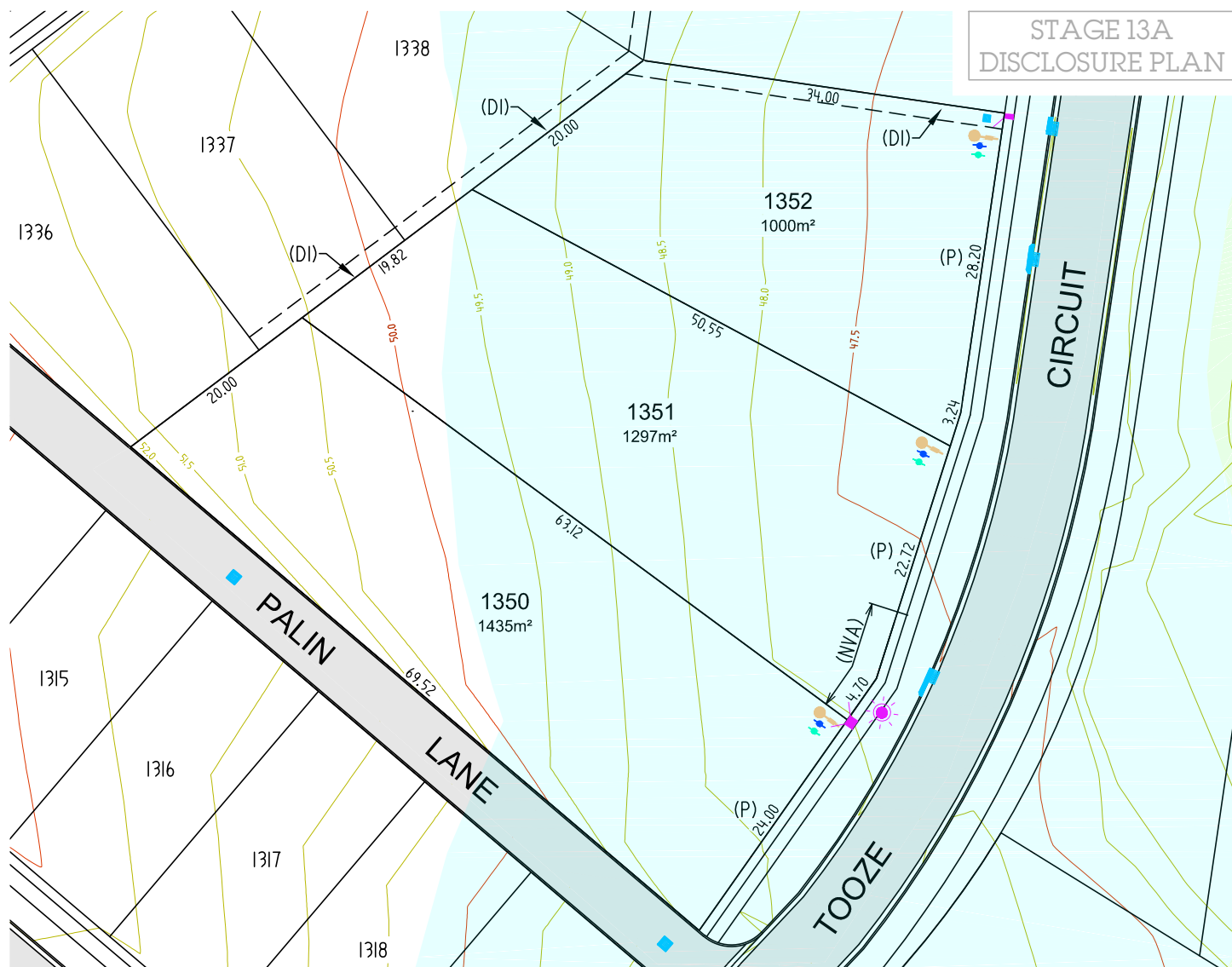

KATHERINE'S

Landing

STAGE 13A DISCLOSURE PLAN



NOTES:

- CONTOURS SHOWN ARE PROPOSED FINISHED SURFACE LEVELS TO THE AUSTRALIAN HEIGHT DATUM (AHD) AT 0.5m INTERVALS. CHANGES IN LEVELS LESS THAN 0.5m ARE NOT SHOWN FOR CLARITY.
- LEVELS AND SERVICE LOCATIONS SHOULD NOT BE RELIED UPON FOR DESIGN PURPOSES AND SHOULD BE CONFIRMED PRIOR TO HOUSE DESIGN.
- LOT TYPES ARE AS FOLLOWS:

3.1. COTTAGE LOT TYPE:	NOT ON THIS SHEET
3.2. SMALL TRADITIONAL LOT TYPE:	NOT ON THIS SHEET
3.3. TRADITIONAL LOT TYPE:	NOT ON THIS SHEET
3.4. LARGE TRADITIONAL LOT TYPE:	LOT 1350 - 1352
3.5. COUNTRY LOT TYPE:	NOT ON THIS SHEET
3.6. MULTI-DWELLING LOT TYPE:	NOT ON THIS SHEET
- REFER TO THE HUNTLEE DEVELOPMENT CONTROL PLAN (DCP) AND DESIGN GUIDELINES FOR FULL DETAILS OF BUILDING SETBACK REQUIREMENTS RELATING TO EACH LOT TYPE
- PLEASE REFER TO THE DCP AND/OR DESIGN GUIDELINES FOR SETACK, SITE COVERAGE AND OTHER BUILDING CONTROLS.
- A 1M ARTICULATION ZONE CAN BE PROVIDED WITHIN FRONT SETBACK.
- FINAL BUSHFIRE REQUIREMENTS AND BAL RATINGS SHOULD BE DISCUSSED WITH THE BUILDER. COUNCIL DA MAY REQUIRE A LOT SPECIFIC BUSHFIRE REPORT TO BE PREPARED BY THE OWNER TO CONFIRM THE APPLICABLE BAL RATING FOR THE DWELLING.
- COTTAGE LOT FENCING & MAILBOX IS INSTALLED BY HUNTLEE AS PER HUNTLEE DESIGN

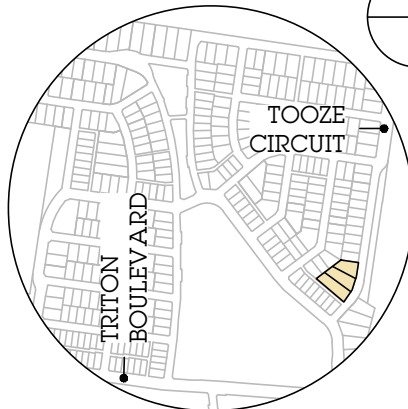

SITE MAP

SD	DM	MM	BC	PD
✓	✓	✓	✓	✓

LEGEND

- (P) PRIMARY FRONTAGE
- (DI) EASEMENT FOR DRAINAGE OF WATER (1.5m WIDE)
- (NVA) NO VEHICULAR ACCESS
- ELECTRICAL, GAS AND NBN
- HOUSE SERVICE
- STREET LIGHT
- STORMWATER PITS
- WATER METER (DRINKING)
- WATER METER (RECYCLED)
- SEWER PIT

BUSHFIRE RATINGS (BAL)

12.5	19	29	40	FZ
------	----	----	----	----



DALY.SMITH
EXPERIENCE YOU CAN TRUST

ALL DIMENSIONS AND AREAS ARE SUBJECT TO SURVEY. THE PARTICULARS ON THIS BROCHURE ARE SUPPLIED FOR INFORMATION ONLY AND SHOULD NOT BE TAKEN AS A REPRESENTATION IN ANY RESPECT ON THE PART OF THE VENDOR OR ITS AGENT.

